

2.1 MEGA PIXEL HD-SDI x30 ZOOM 30 IR LED RUGGED PTZ CAMERA

WRO-WE30D30

QR CODE



IR LED VISIBILITY RANGE

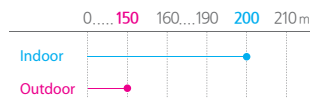

ACCESSORY (Option)



PTZ Controller



KEY FEATURES

- 1/3" PANASONIC New Generation CMOS Image Sensor
- Using Progressive Scan and Auto WDR
- x30 Optical Zoom & x32 Digital Zoom (Total x960 Zoom)
- Super IR LED 30ea (Light Distance 200m / Manual Focusing)
- True Day & Night (Auto ICR)
- NR (Noise Reduction)
- Defog
- Smart IR
- HD-SDI and Analog CVBS Output
- Up to 255 Preset Positions
- Variable Speed Control for All Motorized Functions
- 360° Unobstructed Rotation Using the Heavy Duty Long Life Slip Ring
- RS-485, RS-422 Communication
- Built-in Wiper
- IP66 Weatherproof

DIMENSIONS

Unit : mm

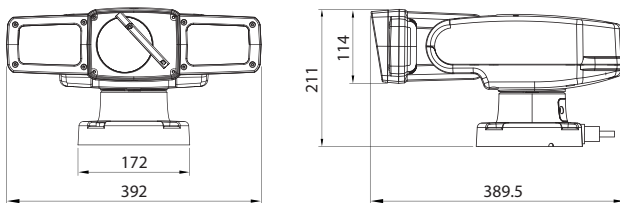

SPECIFICATIONS

WRO-WE30D30		
Image Sensor	1/3" PANASONIC New Generation CMOS	
Picture Elements	1920 x 1080 pixels	
Lens	x30 Optical Zoom / f=4.3~129.0mm / F1.6~F5.0	
IR LED	OSRAM 870nm, 1W, 30ea	
	Length : 200m (Manual focusing)	
Digital Zoom	x32 (x640 with Digital Zoom)	
Angle of View (H)	Appx. 65.1° (Wide end) / Appx. 2.34° (Tele end)	
Min. Working Distance	100mm (Wide end) / 800mm (Tele end)	
Sync System	Internal	
Min. Illumination	Color : 0.5Lux / BW : 0.1Lux / Color DSS : 0.002Lux / BW DSS : 0.001Lux	
Recommended Illumination	100 ~ 100,000Lux	
S/N Ratio	50dB (Weight On)	
BLC	On / Off	
Electronic Shutter Speed	1/30 (1/25) ~ 1/60,000sec	
White Balance	Auto, ATW, Indoor, Outdoor, One Push WB, Manual WB, Outdoor Auto, Sodium Vapor	
Gain Control	Auto / Manual (-3dB ~ +28dB, 16 steps)	
WDR	On / Off / Auto	
NR	On / Off (Level 5~1 / Off, 6 steps)	
Color Enhancement	On / Off	
Aperture Control	16 steps	
Video Output	HD-SDI	1 channel (1080i60, 1080p30, 720p60, 1080i50, 1080p25, 720p50)
	CVBS	1 channel
Communication	RS-422 (4 wire), RS-485 (2 wire)	
Pan	Angle	360° continuous Pan
	Manual Speed	0.1°~ 90°/sec (64 step proportional to zoom)
	Preset Speed	150°/sec, ±0.1° accuracy
Tilt	Angle	180° (±90°)
	Manual Speed	0.1°~ 90°/sec (64 step proportional to zoom)
	Preset Speed	150°/sec, ±0.1° accuracy
Motor	Holding Torque	13.5kgf/cm, 1.35N.m
	Step Angle	1.8°
	Winding Type	Bipola
IP Protection Grade	IP66	
Material	Aluminum	
Temperature	Operating	-20°C ~ +50°C
	Storage	-20°C ~ +60°C
	Fan	-10°C ~ +40°C (4 step control)
	Heater	-10°C ~ 0°C (4 step control)
Operating Humidity	50% ~ 90% (4 step control)	
Power	Voltage	DC 11.5V ~ DC 30V
	Current	DC 15V, 8A
	Heater / Fan	10W / 3.4W
Dimension	392(W) x 211(H) x 389.5(D)mm	
Weight	Appx. 11.6kg	

• Design and specification are subject to change without notice.